

# 2021 MEMBERSHIP DIRECTORY

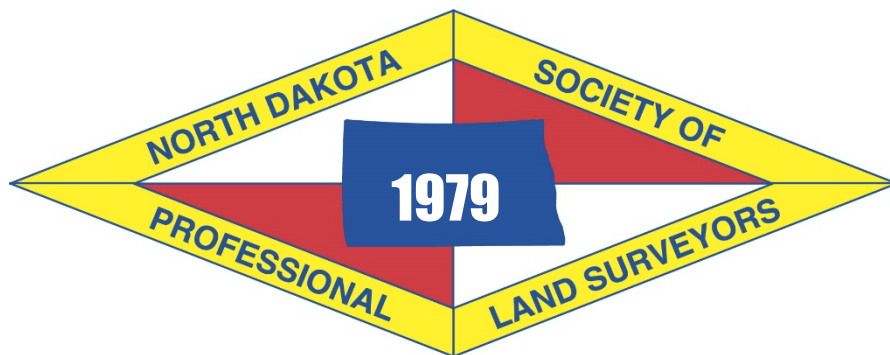

## NORTH DAKOTA SOCIETY OF PROFESSIONAL LAND SURVEYORS

*Affiliate of the National Society of Professional Surveyors*

### Table of Contents

Officers and Directors .....	2
Committees and Chairmen .....	2
Survey Excellence Awards.....	3
Past Presidents .....	3
Membership Listing .....	4
Membership Data.....	28
Membership Application .....	29

PO Box 7370  
Bismarck, ND 58507  
Phone: 701-222-3184  
Email: [info@ndspls.org](mailto:info@ndspls.org)  
Website: [www.ndspls.org](http://www.ndspls.org)

# 2021 Officers & Directors

**President**  
Tom Leshovsky

**President Elect**  
Carl Olson

**Vice President**  
Robert Illg

**Secretary**  
Aaron Hummert

**Treasurer**  
Tom Weigel

**Past President**  
Jason Main

**Flatlanders Chapter**  
Ryan Link

**Badlands Chapter**  
Kirk Jorgenson

**Great Plains Chapter**  
Jeff Jelinek

**Missouri Breaks Chapter**  
Ed Rintamaki

**Missouri River Chapter**  
Kris Johnson

**Northern Lights**  
Tom Lambrecht

**NSPS Director**  
Jason Ness

# 2021 Committees & Chairmen

Admin. Secretary ..... Aaron Hummert  
Awards..... Chris Jordheim  
2020 Convention ..... Northern Lights Chapter  
Education ..... Larry Smith & Carl Olson  
Education Assistance Program..... Brett Zeltinger  
Ethics..... Jason Main  
GIS..... Aaron Norby  
Manual of Practice for Land Surveying in ND..... Greg Johnson  
Historical..... LeRoy Kautz & Russ Kastle  
Industry Committee ..... Ed Rintamaki  
Legislation & Bylaws..... Aaron Hummert  
Membership ..... Robert Illg  
Nominations ..... Jason Main  
Policy & Procedures Manual ..... Great Plains Chapter  
Public Information ..... Todd Norton  
Right of Entry ..... Jason Ness  
Tri-Star ..... Jeff Jelinek  
UAV Committee ..... Greg Obrigewitsch  
Web Site ..... Dayne Solem  
Young Surveyors ..... Jordyn Hjeldness  
New Datum ..... Kris Johnson

---

NDSPLS Administrative Office  
PO Box 7370  
Bismarck, ND 58501

Staiger Consulting Group  
Administrative Secretary

Phone: 701.223.3184  
Email: [info@ndspls.org](mailto:info@ndspls.org)  
Website: [www.ndspls.org](http://www.ndspls.org)

## SURVEY EXCELLENCE AWARD

Russell E. Kastle	1987
Carl S. Vender	1988
Harold G. Lusk	1989
Alan W. Erickson	1990
Kenneth J. Link	1992
Doug Herzog	1996
Greg Johnson	1997
Steve Ackerman	1998
Ray LeClerc	1999
Mark Aughtman	2002
Rolly Ackerman	2003
Larry Smith	2004
Rick Leach	2005
Larry Smith	2006
Leland Krein	2008
LeRoy Kautz	2010
Brian Portwood	2013
Curt Glasoe	2014
Matt Weeks	2015
Bruce Zelmer	2016
LeRoy Kautz	2017
Aaron Hummert	2019
John Steve Perrish	2020

## PAST PRESIDENTS

T. S. Madson	Feb 16, 1979
DeLane R. Meier	1979 1981
Carl S. Vender	1981 1983
Kenneth J. Link	1983 1984
Rodney A. Westrum	1984 1985
Rolly B. Ackerman	1985 1986
Douglas A. Herzog	1986 1987
Gregory L. Johnson	1987 1988
Michael P. Fandrich	1988 1989
Curtis W. Glasoe	1989 1990
Brian J. Rittenhouse	1990 1991
Donald F. Kaufman	1991 1992
Larry J. Smith	1992 1993
Rodney A. Westrum	1993 1994
Leo J. Horgan	1994 1995
Gary Bean	1995 1996
Steve Ackerman	1996 1997
Michael Zimny	1997 1998
Gary Ness	1998 1999
Robert D. Zahn	1999 2000
Roger Grimsley	2000 2001
Matt Weeks	2001 2002
Michael Sansom	2002 2003
Mark Aughtman	2003 2004
Rick Leach	2004 2005
Kent Orvik	2005 2006
Jim Alber	2006 2007
Steve Volesky	2007 2008
Dan Fischer	2008 2009
Robert Procive	2009 2010
Holly Beck	2010 2011
Kirk Jorgenson	2011 2012
Tim Langerud	2012 2013
Chris Jordheim	2013 2014
Steve Langlie	2014 2015
Gregg Orvik	2015 2016
Aaron Hummert	2016 2017
Charles Rebsch	2017 2018
Ed Rintamaki	2018 2019
Jason Main	2019 2020
Tom Leshovsky	2020 2021
Tom Leshovsky	2021 2022

**Ackerman, Rolly**

Ackerman Surveying & Assoc.  
1907 17th St SE  
Minot, ND 58701-  
ID: LS-2391  
W: (701)838-0786  
H: (701)838-3863  
C:  
Email: ackerman@minot.com

**Ackerman, Steven**

8044 182 Ave SE  
Wahpeton, ND 58075-  
ID: LS-2958  
W:  
H: (701)642-5446  
C: (701)899-4273  
Email: steve@ackermansurvey.com

**Alber, James**

Moore Engineering Inc.  
8312 White Oak Loop  
Bismarck, ND 58501-  
ID: LS-4730  
W: (701)663-0718  
H: (701)866-0286  
C: (701) 866-0286  
Email: jim.alber@mooreengineeringinc.com

**Aughtman, Mark**

USDA Forest Service  
99 23rd Street Suite B  
Dickinson, ND 58601-  
ID: LS-3801  
W: (701)227-7835  
H:  
C: (701)290-3542  
Email: maughtman@fs.fed.us

**Bacon, Randy**

Helms & Assoc.  
PO Box 111  
Aberdeen, SD 58402-0111  
ID: LS-3213  
W: (605)225-1212  
H:  
C:  
Email: randyb@helmsengineering.com

**Balluff, Thomas**

Carlson McCain, Inc.  
18612 Xenolith St NW  
Anoka, MN 55303-  
ID: LS-6064  
W: (763)489-7916  
H: (763)753-2575  
C: (763) 443-4644  
Email: balluff\_a@msn.com

**Baltzer, Terry**

Swenson, Hagen & Co.  
909 Basin Ave  
Bismarck, ND 58504-  
ID: LS-3595  
W: (701)223-2600  
H: (701)258-7053  
C:  
Email: tbaltzer@swensonhagen.com

**Bartholomew, Branden**

Self  
1562 Kingsview Dr  
Grand Forks, ND 58201-  
ID: LS-3085  
W:  
H:  
C: (218)791-6964  
Email: b.bartholomew3085@gmail.com

**Beck, Holly**

Holly Beck Surveying & Engineering  
1431 Eagle Crest Loop  
Bismarck, ND 58503-  
ID: LS-4934  
W: (701)223-3546  
H: (701)258-0370  
C: (701)400-8768  
Email: hollybeck@hollybecksurveying.com

**Beggs, Bryan**

Retired  
3001 11th St SE  
Minot, ND 58701-  
ID: LS-1556 - LIFE  
W:  
H: (701)838-3269  
C:  
Email: bbeggs@wil.midco.net

**Berard, Rob**

Ackerman Surveying  
PO Box 104  
Burlington, ND 58722-  
ID: LS-4727  
W: (701)838-0786  
H: (701)839-8526  
C:  
Email: rberard@srt.com

**Berg, Casey**

Advanced Engineering  
4050 Garden View Dr #200  
Grand Forks, ND 58201-  
ID: LS-7191  
W: (701)746-8087  
H: (701)739-4130  
C: (701)740-5847  
Email: casey.berg@ae2s.com

**Bloomenrader, Scott**

330 Rice Lane  
Billings, MT 59105-  
ID: LS-3290  
W:  
H: (406)252-2917  
C: (406) 694-8650  
Email: sbloomenrader@aol.com

**Borgen, Jerome**

Retired  
10223 461 Ave  
New Effington, SD 57255-6103  
ID: LS-1406 - LIFE  
W:  
H: (605)637-5531  
C:  
Email: zborgens@tnics.com

**Brecht, Mary**

The Coteau Properties  
204 County Road 15  
Beulah, ND 58523-  
ID: LS-3921  
W: (701)873-7265  
H:  
C:  
Email: mary.brecht@nacoal.com

**Cichos, Nick**

Interstate Engineering  
1903 12th Ave SW  
Jamestown, ND 58401-  
ID: ASC  
W: (701)252-0234  
H: (701)320-9045  
C: (701)320-4293  
Email: nick.cichos@interstateeng.com

**Cooper, James**

KLJ  
405 6th Ave West  
Dickinson, ND 58601-  
ID: LS-5501  
W: (701) 751-8378  
H: (701)490-0921  
C:  
Email: james.cooper@kljeng.com

**Eckroth, Thomas**

Ducks Unlimited  
1621 Northview Lane  
Bismarck, ND 58501-  
ID: LS-3384  
W: (701) 221-8415  
H: (701)223-5681  
C: (701) 426-0279  
Email: teckroth@yahoo.com

**Eldevik, Rodney**

Eldevik Land Surveying, Inc.  
1211 Maple Dr SE  
Alexandria, MN 56308-  
ID: LS-3409  
W: (320)763-7566  
H: (320)763-7566  
C:  
Email: eldevik@rea-alp.com

**Wood, Jeremy**

Northern Plains Engineering  
441 23rd Street W  
Dickinson, ND 58601-  
ID: LS-5651  
W: (701) 483-1858  
H: (701)483-5080  
C: (701) 690-8076  
Email: jwood@nplainseng.com

**Hummert, Aaron**

Interstate Engineering  
1901 31st St NW  
Mandan, ND 58554-  
ID: LS-7512  
W: (701) 426-8624  
H: (701)663-5455  
C: (701) 426-8624  
Email: hummertsurveying@gmail.com

**Carlson, Arlee**

Sunde Land Surveying, LLC  
9001 E Bloomington Frwy, #11B  
Bloomington, MN 55420-  
ID: LS-6373  
W: (952) 881-2455  
H: (763)427-8139  
C: (612) 328-5312  
Email: arlee@sunde.com

**Johnson, Kris**

NDDOT  
2708 Mercury Lane  
Bismarck, ND 58503-  
ID: LS-10169  
W: (701) 328-4330  
H: (701)955-2387  
C:  
Email: kjjohnson@nd.gov

**Coulombe, George**

Coulombe Consulting  
3701 Elliot Road NE  
Bemidji, MN 56601-  
ID: LS-6262  
W: (218) 760-2508  
H: (218)444-9791  
C: (218)760-2508  
Email: cconsult@paulbunyan.net

**Erickson, Dain**

Apex Engineering Group  
3829 South Sedona Drive  
West Fargo, ND 58078-  
ID: LS-5582  
W: (701) 373-7973  
H: (701)492-2768  
C: (701)793-4382  
Email: dain.erickson@apexenggroup.com

**Fischer, Daniel**

Fischer Land Surveying & Engineering  
PO Box 66  
Langdon, ND 58249-0066  
ID: LS-3856  
W: (701)256-5728  
H: (701)256-2787  
C: (701)370-0690  
Email: dfischer@utma.com

**Floden, Gerald**

Retired  
PO Box 321  
Perham, MN 56573-  
ID: LS-2036 - LIFE  
W:  
H:  
C: (701)793-3355  
Email: Gerry@gfloden.com

**Fowlds, Brian**

Midwest Land Surveying Inc.  
211 E 14th St, #100  
Sioux Falls, SD 57104-  
ID: LS-4625  
W: (605)339-8901  
H: (605)351-7497  
C:  
Email: brianf@midwestlandsurveying.com

**Frohlich, Jeff**

RETIRED  
622 N Mandan St  
Bismarck, ND 58501-  
ID: LS-3139  
W: (701) 226-7954  
H:  
C: (701) 226-7954  
Email: chefrolake@bis.midco.net

**Frontier Precision,**

Frontier Precision  
2020 Frontier Drive  
Bismarck, ND 58504-  
ID: SUS  
W: (701)222-2030  
H:  
C:  
Email: nathank@frontierprecision.com

**Glaoe, Curtis**

Glaoe Surveying  
1636 32nd ST E  
Dickinson, ND 58601-  
ID: LS-2439  
W:  
H: (701)225-5796  
C: (701)260-9459  
Email: curtglasoe@ndsupernet.com

**Glasser, Jamie**

Highlands Engineering & Surveying  
319 24th Street E  
Dickinson, ND 58601-  
ID: LS-5771  
W: (701)483-2444  
H:  
C:  
Email: glasser@highlandseng.com

**Heath, Brian**

KLJ  
1010 4th Ave SW  
Valley City, ND 58072-  
ID: LS-7538  
W: (701) 845-9419  
H:  
C:  
Email: brian.heath@kljeng.com

**Heglund, Dale**

NDSU/UGPTI  
8100 Sibley Drive  
Bismarck, ND 58504-  
ID: LS-3340  
W: (701) 318-6893  
H:  
C: (701) 318-6893  
Email: dale.heglund@ndsu.edu

**Herzog, Doug**

3120 24th Ave S  
Grand Forks, ND 58201-  
ID: LS-2355 - Life  
W:  
H:  
C: (701)739-0054  
Email: daherzog@gra.midco.net

**Hoffart, Brian**

Minnkota Power  
5301 32nd Avenue S  
Grand Forks, ND 58201-  
ID: LS-5071  
W:  
H:  
C: (701) 739-6024  
Email: bhoffart@minnkota.com

**Holm, Steven**

Moore Engineering, Inc.  
29926 70th Ave S  
Hawley, MN 56549-  
ID: LS-6571  
W: (701) 282-4692  
H:  
C: (218) 850-0148  
Email: steve.holm@mooreengineeringinc.com

**Hornaday, Rick**

Hornaday Land Surveying  
704 Coneflower Drive  
Minot, ND 58701-  
ID: LS-3541  
W: (701) 839-5502  
H: (701)839-5502  
C:  
Email: hornaday@srt.com

**Hovendick, David**

LSS, Inc.  
1417 Prairiewood Lane  
Warwick, ND 58381-  
ID: LS-3612  
W: (701)662-8065  
H: (701)398-3255  
C: (701)230-2614  
Email: lss@gondtc.com

**Indvik, Donald**

Retired  
606 W Pine Circle  
Bottineau, ND 58318-  
ID: LS-1263 - LIFE  
W:  
H: (701)228-2976  
C: (701) 201-0194  
Email: dindvik@utma.com

**Irwin, Leland**

Coteau Properties  
204 County Rd 15  
Beulah, ND 58523-  
ID: LSIT-11872  
W: (701)873-7236  
H: (701)843-8460  
C:  
Email: leland.irwin@nacoal.com

**Jackson, Eugene**

1067 5th Avenue W  
Dickinson, ND 58601-  
ID: LS-1891 - LIFE  
W:  
H: (701)483-1340  
C: (701) 290-7155  
Email:

**Jeffries, Jerry**

Golden Field Services  
10830 E. 45th, Suite 405  
Tulsa, OK 74147-  
ID: LS-1247  
W: (918)610-0014  
H: (918)473-6723  
C: (918)638-3317  
Email: jljeffries@goldenfieldservices.com

**Jelinek, Jeff**

NDSCS  
800 6th St N  
Wahpeton, ND 58076-  
ID: LS-5868  
W: (701)671-2268  
H: (701)640-1891  
C: (701)640-1891  
Email: jeff.jelinek@ndscs.edu

**Jensen, Cleone**

3837 N Valley Loop, Box 2  
Bismarck, ND 58503-  
ID: LS-1229 - LIFE  
W:  
H: (701)751-0618  
C:  
Email: jensenf@bis.midco.net

**Jensen, Troy**

Uintah Engineering & Land Surveying  
104 2nd Ave SW, Suite 300  
Sidney, MT 59270-  
ID: LS-4654  
W: (406)433-9650  
H: (406)488-7330  
C: (406)480-0906  
Email: tjensen@uintahgroup.com

**Johnson, Gregory**

Gregory Johnson Surveying  
6404 Deereewood Lane  
Bismarck, ND 58503-  
ID: LS-2356  
W: (701) 220-2494  
H:  
C: (701) 220-2494  
Email: duckschief@bis.midco.net

**Johnson, Jared**

Ward County Hwy Dept.  
200 72nd ST SE  
Ward County, ND 58701-  
ID: ASC  
W: (701)838-2810  
H:  
C:  
Email: jaredjohnson@srt.com

**Johs, Cleary**

City of Bismarck  
3209 Nevada Street  
Bismarck, ND 58503-  
ID: LS-5288  
W: (701)355-1516  
H: (701)224-1589  
C: (701)202-1200  
Email: cjohs@bismarcknd.gov

**Jordheim, Christopher**

Widseth Smith Nolting & Assoc.  
1406 Elm Coulee Dr NE  
Thompson, ND 58278-  
ID: LS-5773  
W: (701)795-1975  
H: (701)599-2321  
C: (218)779-8696  
Email: chris.jordheim@wsn.us.com



**Jorgenson, Kirk**

KLJ  
1463 I-94 Business Loop East  
Dickinson, ND 58601-  
ID: LS-3592  
W: (701)483-1284  
H: (701)225-1644  
C: (701)260-3638  
Email: kirk.jorgenson@kljeng.com

**Jung, James**

Retired  
51430 176th Ave Way  
Pine Island, MN 55963-6720  
ID: LS-2357 LIFE  
W:  
H: (701)840-1781  
C: (701) 840-1781  
Email: jamesjung80@gmail.com

**Kastelle, Russell**

Kastelle Land Surveying  
409 North 13th St  
Breckenridge, MN 56520-  
ID: LS-1170  
W: (218)643-1429  
H:  
C:  
Email: rek@wah.midco.net

**Kautz, LeRoy**

Interstate Engineering  
248 19th Ave NE  
Jamestown, ND 58401-  
ID: LS-1177  
W: (701)252-0234  
H: (701)952-1177  
C: (701)320-4289  
Email: ledodkautz@daktel.com

**Kisch, Kurt**

Ulteig  
9867 Revere Lane  
Maple Grove, MN 55369-  
ID: LS-4597  
W: (651) 415-6667  
H: (763)425-2955  
C: (612) 250-4533  
Email: kurt.kisch@ulteig.com

**Kitzan, Rudy**

RFK Land Surveying  
1420 W Garland Ave  
Spokane, WA 99205-  
ID: LS-4184  
W: (509)324-7861  
H:  
C: (509)990-9071  
Email: rudy@rfklandsurveying.com

**Kohler, Richard**

Retired  
2911 Harder Drive  
Gillette, WY 82718-  
ID: LS-2758 - LIFE  
W: (307)686-6750  
H: (307)686-9168  
C:  
Email: dkohler326@msn.com

**Kohler, Robert**

BEPC  
1309 E Divide Ave  
Bismarck, ND 58501-  
ID: LS-6718  
W: (701) 516-4434  
H: (701)516-4434  
C: (701) 516-4434  
Email: rkohler@bepc.com

**Krebs, Mathias**

Retired  
1123 9th St E  
Dickinson, ND 58602-  
ID: LS-3214 LIFE  
W:  
H:  
C: (701)260-3607  
Email: matt.krebs97@gmail.com

**KREIN, LELAND L**

4011 CONNAR DR  
Bismarck, ND 58503-  
ID: LS-3148 Life  
W:  
H:  
C:  
Email: lkrein@state.nd.us

**Krug, Patrick**

CPS, LTD  
308 2nd Ave N  
Grand Forks, ND 58201-  
ID: LS-3289  
W: (701) 746-7459  
H:  
C: (701) 330-1009  
Email: pat.krug@cpsengineering.net

**Lambrecht, Mark**

AE2S  
4050 Garden View Dr #200  
Grand Forks, ND 58201-  
ID: LS-2511  
W: (701)746-8087  
H: (218)791-2477  
C: (218) 791-2477  
Email: mark.lambrecht@ae2s.com

**Lambrecht, Tom**

AE2S  
1115 16th St SW #2  
Minot, ND 58701-  
ID: LS-9539  
W: (701) 852-4048  
H:  
C: (701)740-5325  
Email: tom.lambrecht@ae2s.com

**Langerud, Tim**

Swenson, Hagen & Co.  
909 Basin Ave  
Bismarck, ND 58504-  
ID: LS-5770  
W: (701)223-2600  
H:  
C:  
Email: tlangerud@swensonhagen.com

**Langlie, Steve**

36465 380th Avenue  
Richville, MN 56576-  
ID: LS-5476  
W:  
H: (701)390-4919  
C: (701) 390-4919  
Email: stevelanglie5476@gmail.com

**Leshovsky, Thomas**

Wold Engineering, PC  
110 8th Ave SW  
Minot, ND 58701-  
ID: LS-6134  
W: (701)852-0338  
H: (701)838-8305  
C: (701)720-2416  
Email: tomsky@srt.com

**Liebold, Felix**

KLJ  
1010 4th Ave SW  
Valley City, ND 58072-  
ID: LS-8441  
W: (701) 845-9426  
H: (701)778-7342  
C: (701)490-1340  
Email: felix.liebold@kljeng.com

**Link, Kenneth**

613 4th Street NE  
Hazen, ND 58545-  
ID: LS-1242  
W:  
H: (701)748-2827  
C:  
Email: kenlink@westriv.com

**Link, Ryan**

CPS, LTD  
308 2nd Ave N  
Grand Forks, ND 58203-  
ID: LS-7590  
W: (701)746-7459  
H:  
C: (701) 740-2430  
Email: ryan.link@cpsengineering.net

**Loomer, Donald**

4904 Prairie Lane  
Williston, ND 58801-  
ID: LS-2681  
W:  
H: (701)774-3674  
C: (701) 770-2576  
Email: dloomer@nemont.net

**Madler, Charles**

CMMadler, LLC  
23 Tom Ral Drive  
Spearfish, SD 57783-  
ID: LS-2870  
W: (406) 941-0886  
H: (605)559-0104  
C: (406) 941-0886  
Email: cmmadler@gmail.com

**Manchester, Ronald**

Toman Engineering Co  
501 1st St NW  
Mandan, ND 58554-  
ID: LS-3252  
W: (701) 663-6483  
H:  
C: (701) 400-9396  
Email: ron@tomanengineering.com

**Marquardt, Andra**

Toman Engineering Co  
402 7th St NW  
Mandan, ND 58554-  
ID: LS-4623  
W: (701)663-6483  
H: (701)667-2875  
C:  
Email: amarq013@yahoo.com

**Marschall, Todd**

Houston Engineering  
88 McDougall Drive  
Lincoln, ND 58504-  
ID: LS-4431  
W: (701) 323-0200  
H: (701)223-2345  
C:  
Email: tmarschall@houstoneng.com

**May, George**

Retired  
34142 Camp Cherith RD  
Frazee, MN 56544-  
ID: LS-2360 - LIFE  
W:  
H: (218)334-4275  
C:  
Email:

**McDonald, Dan**

ND State Water Commission  
900 E Boulevard Ave  
Bismarck, ND 58506-  
ID: ASC  
W: (701)328-3093  
H:  
C: (701) 202-6748  
Email: dmcdonald@nd.gov

**McElwain, Jeffery**

Ackerman-Estvold Engineering  
1907 17th St SE  
Minot, ND 58701-  
ID: ASC  
W: (701)837-8737  
H: (701)839-6821  
C: (701)720-4038  
Email: jmcElwain@srt.com

**Mead, Todd**

KLJ  
4585 Coleman Street  
Bismarck, ND 58503-  
ID: PLS  
W: (701) 355-8400  
H: (701)290-7756  
C: (651) 491-9572  
Email: todd.mead@kljeng.com

**Moore, Courtney**

Widseth Smith Nolting  
3535 31st Street South, Ste 203  
GRAND FORKS, ND 58201-  
ID: ASC  
W: (701) 765-8035  
H: (701)799-3163  
C: (218) 230-8994  
Email: courtney.moore@wsn.us.com

**Ness, Gary**

Mead & Hunt  
8 Seventh St N  
Fargo, ND 58102-  
ID: LS-3461  
W: (701) 566-6451  
H:  
C: (701)799-8927  
Email: gary.ness@meadhunt.com

**Ness, Jason**

Mead & Hunt, Inc.  
1389 140th Ave NE  
Hatton, ND 58240-  
ID: LS-6884  
W: (701) 566-6452  
H:  
C: (218) 779-8239  
Email: jason.ness@meadhunt.com

**Norby, Aaron**

KLJ  
4585 Coleman Street  
Bismarck, ND 58503-  
ID: LS-5589  
W: (701) 355-8400  
H: (701)223-2756  
C:  
Email: aaron.norby@kljeng.com

**Norton, Todd**

AE2S  
1815 Schafer Street #301  
Bismarck, ND 58501-  
ID: LS-4624  
W: (701)221-0530  
H: (701)843-8719  
C:  
Email: Todd.Norton@ae2s.com

**Obrigewitch, Greg**

The Falkirk Mining Company  
1513 Prairie Hawk Drive  
Bismarck, ND 58503-  
ID: LS-4114  
W: (701)250-2412  
H: (701)870-5469  
C: (701)870-5469  
Email: greg.obrigewitch@nacoal.com

**Obrigewitsch, Quentin**

KLJ  
1463 I-94 Business Loop East  
Dickinson, ND 58601-  
ID: LS-5999  
W: (701)483-1284  
H:  
C:  
Email: quentin.obrigewitsch@kljeng.com

**Olson, Carl**

RETIRED  
1208 42nd Ave N  
Fargo, ND 58102-  
ID: LS-4687  
W: (218)287-0300  
H: (701)239-2518  
C: (218)790-2931  
Email: carl.olson@kljeng.com

**Olson, Peter**

Self-Employed  
PO BOX 729  
Culbertson, MT 59218-0729  
ID: LS-5281  
W:  
H: (406)787-5215  
C: (406)480-1608  
Email: paolsonfh4@yahoo.com

**Orvik, Gregg**

KLJ  
2900 10th SW Ste A  
Minot, ND 58702-0250  
ID: LS-3881  
W: (701)839-3383  
H: (701)839-1436  
C: (701)720-0234  
Email: gregg.orvik@kljeng.com

**Orvik, Kent**

Retired  
10129 Ewing Lane N  
Brooklyn Park, MN 55443-  
ID: LS-3463  
W:  
H: (701)222-4536  
C: (612) 404-4268  
Email: kent.orvik@hotmail.com

**Paulson, John**

Brosz Engineering  
PO Box 781  
Bowman, ND 58623-  
ID: LS-3366  
W: (701)523-3340  
H: (701)523-5547  
C:  
Email: johnp@broszengineering.com

**Peterka, Daren**

Interstate Engineering, Inc.  
3210 6th Ave NW  
Jamestown, ND 58401-  
ID: LS-4358 - PE  
W: (701)252-0234  
H: (701)952-5238  
C: (701)320-4292  
Email: darenp@daktel.com

**Pribula, Gerald**

Pribula Engineering  
14796 450th Ave NW  
E Grand Forks, MN 56721-  
ID: LS-2257  
W: (701)772-7058  
H: (218)773-9300  
C:  
Email:

**Pribula, Nicholas**

Pribula Engineering, PLLC  
3210 Belmont Rd  
Grand Forks, ND 58201-  
ID: LS-8587  
W: (701) 772-7058  
H: (701)388-8450  
C: (701) 388-8450  
Email: npribula@gmail.com

**Privratsky, James**

1053 Dell Avenue  
Dickinson, ND 58601-  
ID: LS-3878 Life  
W:  
H: (701)225-1045  
C: (701)260-2318  
Email: ajjism@ndsupernet.com

**Procive, Robert**

Interstate Engineering, Inc  
12760 35th St SW  
Belfield, ND 58622-  
ID: LS-2884  
W: (701)575-2247  
H: (701)575-4099  
C: (701)290-5775  
Email: robert.procive@interstateeng.com

**Richter, James**

City of Grand Forks  
255 N 4th St, PO Box 5200  
Grand Forks, ND 58206-  
ID: ASC  
W:  
H:  
C:  
Email: jrichter@grandforksgov.com

**Rudolph, Kirby**

Holly Beck Surveying & Engineering  
1027 N. 29th Street  
Bismarck, ND 58501-  
ID: ASC  
W: (701)223-3546  
H: (701)226-4801  
C:  
Email: krudolph@hollybecksurveying.com

**Sansom, Michael**

CPS, LTD  
308 2nd Ave N  
Grand Forks, ND 58203-  
ID: LS-3141  
W: (701)738-4052  
H:  
C: (218) 791-1676  
Email: mike.sansom@cpsengineering.net

**Sauber, John**

Sauber Engineering  
37 Captain Marsh Dr  
Mandan, ND 58554-  
ID: LS-8427  
W: (701) 751-5993  
H:  
C: (701) 220-3809  
Email: jsauber@sauberengineering.com

**Schaar, Trevor**

The Falkirk Mining Co.  
5422 Dietrich Pl  
Bismarck, ND 58503-  
ID: LSI  
W: (701) 250-2605  
H: (701)391-7498  
C:  
Email: trevor.schaar@nacoal.com

**Schlieman, Jim**

Houston Engineering, Inc.  
1401 21st Ave N  
Fargo, ND 58102-  
ID: LS-6086  
W: (701)237-5065  
H:  
C:  
Email: jschlieman@houstoneng.com

**Seibel, Stanley**

The Coteau Properties  
204 County Road 15  
Beulah, ND 58523-  
ID: LS-3950  
W: (701)873-7242  
H: (701)748-6270  
C:  
Email: stan.seibel@nacoal.com

**Sherlock, Becky**

KLJ  
1701 12th Street SW  
Minot, ND 58701-  
ID: ASC  
W: (701) 839-3383  
H: (701)720-1104  
C:  
Email: becky.sherlock@kljeng.com

**Skarphol, Curtis**

Houston Engineering, Inc.  
17135 54th Street SE  
Horace, ND 58047-9600  
ID: LS-4723  
W: (701) 237-5065  
H: (701)293-0827  
C:  
Email: cskarphol@houstonengineeringinc.com

**Skinner, Daniel**

Rani Engineering  
36556 Perrine Drive  
Rochert, MN 56578-  
ID: LS-6206  
W:  
H: (218)850-0249  
C: (218) 368-9374  
Email: dan.skinner70@gmail.com

**Smith, Larry**

SES Geomatics  
2321 Harding Avenue  
Bismarck, ND 58501-2233  
ID: LS-2363  
W: (701) 220-9843  
H: (701)258-3827  
C: (701) 220-9843  
Email: ljs2363@midco.net

**Solem, Dayne**

Barlett & West  
3456 E Century Ave  
Bismarck, ND 58503-  
ID: LS-8423  
W: (701) 258-1110  
H:  
C: (701) 400-2785  
Email: dayne.solem@bartwest.com

**Stanhope, Bob**

W.B.I. Energy Transmission  
2010 Montana Ave  
Glendive, MT 59330-  
ID: LS-3593  
W: (406)359-7200  
H:  
C: (406)989-1062  
Email: bob.stanhope@wbienergy.com

**Stattelman, Nick**

AE2S  
4170 28th Avenue S  
Fargo, ND 58104-  
ID: LS-8218  
W: (701) 364-9111  
H: (218)230-4358  
C: (218)230-4358  
Email: Nick.Stattelman@ae2s.com

**Swanson, Steven**

AE2S  
4050 Garden View Drive #200  
Grand Forks, ND 58201-  
ID: LS-4185  
W: (701)746-8087  
H:  
C:  
Email: Steve.Swanson@ae2s.com

**Vender, Carl**

Semi-Retired  
6029 Linck Circle  
Shepherd, MT 59079-4416  
ID: LS-1222  
W:  
H: (406)373-0997  
C:  
Email: grandpavender@yahoo.com

**Voegele, Dennis**

Retired  
3629 8R St NW  
Coleharbor, ND 58531-  
ID: LS-2925 - LIFE  
W:  
H: (701)442-5726  
C:  
Email: voegele@westriv.com

**Volesky, Steven**

USDA Forest Service  
60 8th St W  
Dickinson, ND 58601-  
ID: LS-3367  
W: (701)227-7855  
H: (701)483-6992  
C:  
Email: svolesky@fs.fed.us

**Weeks, Matthew**

Compass Rose Consulting  
PO Box 1132  
Bismarck, ND 58502-  
ID: LS-3626  
W: (701) 471-8973  
H: (701)255-2918  
C: (701)471-8973  
Email: mweeks@compassrosend.com

**Westrum, Rodney**

Westrum's Land Surveying  
7010 3rd Ave E  
Williston, ND 58801-  
ID: LS-1195  
W: (701) 774-8605  
H: (701)774-0316  
C: (701) 580-6327  
Email: rwestrum@nemontel.net

**Wicklund, John**

Wicklund Surveying  
1119 University Dr #1016  
Bismarck, ND 58504-  
ID: LS-2491  
W: (701)400-3797  
H: (701)400-3797  
C: (701)400-3797  
Email: jjrw2492@aol.com

**Winkler, Scott**

KLJ  
1010 4TH Avenue SW  
Valley City, ND 58072-  
ID: ASC  
W: (701)845-4980  
H: (701)845-1151  
C: (701)490-1614  
Email: scott.winkler@kljeng.com

**Zelmer, Bruce**

Bartlett & West, INC  
3456 E Century Ave  
Bismarck, ND 58503-  
ID: LS-5672  
W: (701) 221-8349  
H:  
C: (701)226-2961  
Email: bruce.zelmer@bartwest.com

**Zimny, Michael**

Meridian Land Surveys  
1022 E Divide Suite G  
Bismarck, ND 58501-2047  
ID: LS-3132  
W: (701) 258-2424  
H:  
C: (701)471-1861  
Email: michaelzimny@meridianlandsurvey.com

**Appleton, Robert**

US Fish & Wildlife Service  
10555 W Jewell Ave, Apt 10-303  
Lakewood, CO 80232-  
ID: LS-7176  
W: (303) 829-8847  
H:  
C: (720) 413-4037  
Email: appletonrj@q.com

**Sagsveen, David**

Bismarck State College  
1530 Columbia Drive  
Bismarck, ND 58504-

ID: ASC  
W: (701) 224-5443  
H: (701)250-4824  
C:

Email: david.sagsveen@bismarckstate.edu

**Sletvold, Dusty**

1998 Goldenrod Lane  
Sidney, MT 59270-

ID: LS-6885  
W: (406) 488-4532  
H: (406)488-4532  
C:

Email: dsletvold@gmail.com

**Snider, Durham**

Apex Engineering Group  
1303 14 1/2 St S  
Fargo, ND 58103-

ID: LS-8426  
W: (701) 237-6542  
H: (701)298-6237  
C:

Email: durham.snider@outlook.com

**Martin, Kevin**

Bartlett & West  
3456 E Century Ave  
Bismarck, ND 58503-

ID: LS-7062  
W: (701) 258-1110  
H:  
C: (701) 226-1261

Email: kevin.martin@bartwest.com

**Hillius, Joe**

Coeau Properties  
204 County Road 15  
Beulah, ND 58523-

ID: ASC  
W: (701) 873-2281  
H:  
C: (701) 870-0452

Email: joe.hillius@nacoal.com

**Forbes, Brian**

D.R. Griffin & Associates, Inc.  
1414 Elk Street #202  
Rock Springs, WY 82901-

ID: LS-6611  
W: (307) 362-5028  
H: (307)382-9712  
C: (307) 389-4315

Email: bforbes@drg-wy.com

**Stroeing, Gregg**

Bolton & Menk  
4298 Red River Trail SW  
Pillager, MN 56473-

ID: LS-6703  
W: (701) 280-8714  
H:  
C: (320) 333-5873

Email: greggstroeing@gmail.com

**McCoy, Trace**

Meyer-Rohlin Land Services  
708 1st Ave NE #1  
Buffalo, MN 55313-

ID: LS-6808  
W: (763) 682-1781  
H: (320)558-6091  
C:

Email: trace@meyerrohlin.com

**Dolinar, William**

William H Smith & Associates  
1515 9th St Ste A  
Rock Springs, WY 82901-

ID: LS-6550  
W: (307) 875-3638  
H: (307)875-1735  
C: (307) 389-3361

Email: wdolinar@whsmithpc.com

**Wisted, Bradley**

Short Elliott Hendrickson, Inc  
7712 White Overlook Drive  
Breezy Point, MN 56472-

ID: LS-9841  
W: (218) 290-2273  
H: (218)290-2273  
C:

Email: bwisted@sehinc.com



**Stern, Matthew**

Swenson, Hagen & Co.  
909 Basin Ave  
Bismarck, ND 58504-  
ID: LS-8299  
W: (701) 223-2600  
H: (701)934-1969  
C:  
Email: mstern@swensonhagen.com

**Kainz, Robert**

KLJ  
1010 4th Ave SW  
Valley City, ND 58072-  
ID: ASC  
W: (701) 890-6093  
H: (701)789-9473  
C:  
Email: robert.kainz@kljeng.com

**Schirado, Dustin**

Bartlett & West  
3456 E. Century Ave  
Bismarck, ND 58503-  
ID: ASC  
W: (701) 258-1110  
H: (701)527-5988  
C:  
Email: dustin.schirado@bartwest.com

**Jordan, Michael**

Brosz Engineering  
10081 Ventura Lane  
Summerset, SD 57718-  
ID: LS-3542  
W: (605) 347-2722  
H: (605)206-0344  
C:  
Email: mikej@broszengineering.com

**Rude, Steven**

AE2S  
103 1st Ave W #300  
Dickinson, ND 58601-  
ID: LS-6261  
W: (701) 225-6564  
H:  
C:  
Email: steve.rude@ae2s.com

**Wurgler, Jeremy**

Houston Engineering, Inc.  
4440 49th St S  
Fargo, ND 58104-  
ID: LS-6918  
W: (701) 237-5065  
H:  
C: (701) 261-1392  
Email: jwurgler@houstoneng.com

**Erbele, Boyd**

Apex Engineering Group  
4733 Amber Valley Parkway S  
Fargo, ND 58104-  
ID: LS-7986  
W: (701) 373-7978  
H: (701)793-0086  
C: (701) 793-0086  
Email: boyd.erbele@apexenggroup.com

**Rintamaki, Edward**

49th Latitude Land Survey, LLC  
13046 74th St NW  
Alamo, ND 58830-  
ID: LS-7664  
W: (701) 580-2651  
H: (701)528-4342  
C: (701) 580-2651  
Email: erintamaki@49latitudelandsurvey.com

**Small, Michael**

MKEC Engineering  
15931 E. Plymouth Road  
Wichita, KS 67230-  
ID: LS-8220  
W: (316) 684-9600  
H: (316)775-2781  
C: (316) 259-9888  
Email: msmall@mkec.com

**Illg, Robert**

SEH  
4719 Shelburne Street #6  
Bismarck, ND 58503-5677  
ID: LS-8444  
W: (701) 354-7121  
H:  
C: (218) 770-6647  
Email: rillg@sehinc.com

**Jacobson, Matthew**

IMEG  
1817 South Avenue West, Suite A  
Missoula, MT 59801-  
ID: LS-7810  
W: (406) 721-0142  
H:  
C:  
Email: matthew.j.jacobson@imegcorp.com

**Weigel, Tom**

Holly Beck Surveying & Engineering  
3320 Hamilton St., Unit 3  
Bismarck, ND 58503-  
ID: LS-10871  
W: (701) 223-3546  
H: (701)471-7430  
C:  
Email: tweigel@hollybecksurveying.com

**Main, Jason**

Ackerman Surveying & Assoc.  
1907 17th Street SE  
Minot, ND 58701-  
ID: LS-8134  
W: (701) 838-0786  
H: (812)343-0464  
C: (701) 509-3773  
Email: jason.main@ackermansurveying.com

**Tarnowski, Mike**

Mountain Plains  
3306 Jordan Street  
Bismarck, ND 58503-  
ID: PLS  
W: (701) 580-8540  
H:  
C: (701) 580-8540  
Email: mtarnowski@mtnplains.com

**Buzzerd, Gregory**

Wold Engineering  
915 E 11th St, PO Box 237  
Bottineau, ND 58318-  
ID: LS-6985  
W: (701) 228-2292  
H: (910)619-7892  
C:  
Email: gbuzzerd@woldengr.com

**Leas, Jarrett**

KLJ  
1024 Thiesse Dr  
Brainerd, MN 56401-  
ID: LS-8732  
W: (218) 828-6330  
H: (218)963-3534  
C: (218) 443-3830  
Email: jarrett.leas@kljeng.com

**Backowski, Jacob**

KLJ  
1024 Thiesse Dr  
Brainerd, MN 56401-  
ID: LS  
W: (218) 828-6330  
H:  
C:  
Email: jake.backowski@kljeng.com

**Binstock, Daniel**

KLJ  
PO Box 1157  
Bismarck, ND 58502-  
ID: ASC  
W:  
H:  
C: (701) 545-2330  
Email: daniel.binstock@kljeng.com

**Atterton, Chad**

Ackerman Surveying & Associates  
PO Box 538  
Surrey, ND 58785-  
ID: LS-8831  
W: (701) 852-9210  
H: (701)833-3365  
C:  
Email: chad.atterton@ackermansurveying.com

**Brekke, Chris**

Ackerman Surveying  
215 16th Street SE  
Minot, ND 58701-  
ID: LS-9187  
W: (701) 857-9174  
H: (701)500-1103  
C: (701) 500-1103  
Email: chris.brekke@ackermansurveying.com

**Ziska, Jake**

WWC Engineering  
6084 Anna Brown Road  
Helena, MT 59602-  
ID: LS-7390  
W: (406) 443-3962  
H:  
C: (406) 581-4834  
Email: jziska@wwcengineering.com

**Nelson, Joshua**

Wenck Associates  
3513 21st ST S  
Fargo, ND 58104-  
ID: LSI  
W: (701) 306-9685  
H: (701)306-9685  
C: (701) 306-9685  
Email: jnelson@wenck.com

**Griffith, George**

Wood Group Mustang  
6819 Powell Lane  
Manvel, TX 77578-  
ID: PLS-9542  
W:  
H:  
C: (832) 259-0176  
Email: g\_griff@yahoo.com

**Brackey, Leon**

Mountrail-Williams Electric Co-Op  
1814 16th Ct W  
Williston, ND 58801-  
ID: 10135  
W: (701) 577-3765  
H: (701)572-0692  
C: (701) 609-3115  
Email: leonb@mwec.com

**McKenzie, Malcolm**

McKenzie Snyder, Inc.  
996 18th Ave Cir N  
Moorhead, MN 56560-  
ID: ASC  
W: (703) 298-5196  
H: (703)298-5196  
C:  
Email: allojohn1@gmail.com

**Hill, Courtney**

KLJ  
109 36th Ave SE  
Minot, ND 58701-  
ID: ASC  
W: (701) 818-8454  
H: (701)509-6612  
C:  
Email: courtneyhillmon13@yahoo.com

**Skipton, Bruce**

Apex Engineering Group  
2702 Serenity Drive  
St. Cloud, MN 56301-  
ID: LS-8251  
W: (701) 373-7976  
H:  
C: (218) 760-1130  
Email: bruceskipton@gmail.com

**Cermak, Eric**

Bartlett & West  
3456 E Century Ave  
Bismarck, ND 58503-  
ID: ASC  
W: (701) 258-1110  
H:  
C: (701) 425-7237  
Email: eric.cermak@bartwest.com

**Rosas, Antonio**

Bartlett & West  
3456 E Century Ave  
Bismarck, ND 58503-  
ID: ASC  
W: (701) 258-1110  
H:  
C: (701) 527-4131  
Email: antonio.rosas@bartwest.com

**Glaser, Joshua**

KLJ  
2900 10th St SW  
Minot, ND 58701-  
ID: ASC  
W: (701) 839-3383  
H:  
C:  
Email: joshua.glaser@kljeng.com

**Hennessy, James**

Houston Engineering, Inc.  
18 3rd St SE #100  
Minot, ND 58701-  
ID: LS-8961  
W: (701) 852-7931  
H: (307)272-6630  
C: (307) 272-6630  
Email: jhennessy@houstoneng.com

**Zeltinger, Brett**

KLJ  
4585 Coleman Street  
Bismarck, ND 58503-  
ID: PLS-27331  
W: (701) 355-8736  
H:  
C: (701) 721-6247  
Email: brett.zeltinger@kljeng.com

**Eagleshield, Craig**

SRST Land Management  
PO Box D  
Fort Yates, ND 58538-  
ID: ASC  
W: (701) 854-8643  
H:  
C: (701) 455-4573  
Email: ceagleshield@standingrock.org

**Caillier, Adam**

Widseth Smith Nolting & Assoc.  
2850 24th Ave S #201  
Grand Forks, ND 58201-  
ID: ASC  
W: (701) 795-1975  
H: (701)213-6917  
C: (701) 317-0743  
Email: adam.caillier@wsn.us.com

**Crow, Wayne**

Williams County  
PO Box 1305  
Williston, ND 58802-  
ID: LS-8517  
W: (701) 577-5118  
H: (701)651-6021  
C: (701) 570-4511  
Email: waynec@co.williams.nd.us

**Ceroll, Rodney**

Interstate Engineering  
45718 101st St  
New Effington, SD 57255-  
ID: LS-5772  
W: (701) 642-5521  
H: (701)899-0995  
C: (701) 899-0995  
Email: rod.ceroll@interstateeng.com

**Bullinger, Benjamin**

Wold Engineering, PC  
915 East 11th Street  
Bottineau, ND 58318-  
ID: LSI  
W: (701) 871-7542  
H:  
C: (701) 201-0190  
Email: ben\_bullinger@woldengr.com

**Sorenson, Timothy**

Hansen Thorp Pellinen Olson, Inc.  
7510 Market Place Drive  
Eden Prairie, MN 55344-  
ID: LS-8610  
W: (701) 774-3080  
H:  
C: (701) 570-4636  
Email: Tsorenson@htpo.com

**Krumm, Hope**

Houston Engineering  
1930 E Capitol Ave, 308  
Bismarck, ND 58501-  
ID: ASC  
W: (701) 323-0200  
H:  
C: (701) 851-0121  
Email: hkrumm@houstoneng.com

**Karel, Trent**

Houston Engineering Inc.  
1401 21st Ave N  
Fargo, ND 58102-  
ID: LSI  
W:  
H: (701)520-2197  
C:  
Email: tkarel@houstoneng.com

**Young, Mark**

Roughrider Electric Coop  
PO Box 93  
Dickinson, ND 58602-  
ID: LS-10661  
W: (701) 690-6470  
H: (701)300-2336  
C: (701) 300-2336  
Email: myoung92554@hotmail.com

**Austin, Nathaniel**

Wold Engineering, PC  
110 8th Ave SW  
Minot, ND 58701-  
ID: LS-10415  
W: (701) 852-0338  
H:  
C: (701) 822-4001  
Email: naustin@srt.com

**Huenefeld, Curtis**

Holly Beck Surveying & Engineering  
4718 37th Ave NW  
Mandan, ND 58554-  
ID: ASC  
W: (701) 223-3546  
H: (701)955-5645  
C:  
Email: chuenefeld@hollybecksurveying.com

**Duchsherer, Jacob**

Interstate Engineering  
2908 7TH Ave N  
Moorehead, MN 56560-  
ID: ASC  
W: (701) 720-8662  
H:  
C:  
Email: jduchsherer@mooreengineeringinc.com

**Nelson, Kevin**

Mountain Plains, LLC  
5004 Cornice Drive  
Bismarck, ND 58503-  
ID: LS-3638  
W: (701) 955-3153  
H: (701)258-2818  
C: (701) 333-8164  
Email: vinnyg@midco.net

**Weeks, JW**

AE2S  
1815 Schafer St #301  
Bismarck, ND 58501-  
ID: LS-10638  
W: (701) 221-0530  
H:  
C: (701) 955-5829  
Email: jw.weeks@ae2s.com

**Graham, Nicholas**

Houston Engineering  
111 Delaware St  
Bismarck, ND 58504-  
ID: ASC  
W: (701) 323-0200  
H: (701)340-3934  
C:  
Email: ngraham@houstoneng.com

**Uran, Derek**

KLJ  
1463 I-94 Business Loop East  
Dickinson, ND 58601-  
ID:  
W: (701) 483-1284  
H:  
C: (701) 898-4933  
Email: derek.uran@kljeng.com

**Johnson, Matthew**

KLJ  
1010 4th Ave Sw  
Valley City, ND 58072-  
ID: LSI  
W: (701) 845-9415  
H:  
C: (701) 890-5341  
Email: matthew.johnson@kljeng.com

**Taylor, Ricky**

William H Smith and Associates Inc.  
2215 Sims Street  
Dickinson, ND 58601-  
ID: LS-10650  
W: (701) 483-1436  
H:  
C: (307) 389-7019  
Email: rtaylor@whsmithpc.com

**Janes, Jason**

Janes Surveying Inc.  
PO Box 146  
Palmyra, MO 63461-

ID:

W: (576) 769-7020

H:

C:

Email: jason@janessurveying.com

**Ternes, James P.**

ND SWC  
900 E. Boulevard Avenue  
Bismarck, ND 58501-

ID: ASC

W: (701) 328-2304

H: (701)870-0810

C:

Email: jpternes@nd.gov

**Fosse, Alana**

Minnkota Power Cooperative

ID:

W:

H:

C:

Email:

**Johanneck, Patrick**

Houston Engineering  
1401 21st Avenue N  
Fargo, ND 58102-

ID: ASC

W: (701) 499-9449

H:

C:

Email: pjohanneck@houstoneng.com

**Thiel, Alex**

Moore Engineering  
925 10th Avenue E  
West Fargo, ND 58078-

ID:

W: (701) 282-4692

H:

C:

Email: athiel@mooreengineeringinc.com

**Stephens, Brooke**

NDDOT  
3270 45th Avenue  
New Salem, ND 58563-

ID: PLS

W:

H: (701)214-1829

C:

Email: bstephens@nd.gov

**Neiber, Braeden**

Widseth Smith Nolting  
3750 Rummele Road  
Grand Forks, ND 58201-

ID: ASC

W: (701) 864-0484

H:

C: (701) 403-4278

Email: braeden.neiber@wsn.us.com

**Wormley, Michael**

Martin Construction Inc.  
2030 105th Ave SW  
Manning, ND 58642-

ID: LS-28310

W: (701) 456-2543

H:

C: (701) 300-4702

Email: michaelwormley1977@gmail.com

**Rintamaki, Ryan**

49th Latitude Land Survey  
522 9th Ave W  
Williston, ND 58801-

ID: LSI

W: (701) 339-2006

H:

C:

Email: rrintamaki@49latitudelandsurvey.com

**Klug, Alex**

Apex Engineering Group  
1516 34 1/2 Ave S  
Fargo, ND 58104-

ID: ASC

W: (701) 899-2572

H:

C: (701) 899-2572

Email: alex.klug9@gmail.com

**Kauffman, Joseph**

Interstate Engineering  
PO Box 170  
Sidney, MT 59270-  
ID: LS-9153  
W: (406) 433-5617  
H:  
C: (406) 250-9452  
Email: joe.kauffman@interstateeng.com

**Friedt, Jared**

Houston Engineering, Inc.  
5703 Copper Ridge Lane  
Bismarck, ND 58504-  
ID:  
W: (701) 323-0200  
H:  
C:  
Email: jfriedt@houstoneng.com

**Neil, Shultz**

Percheron Professional Services  
238 Georges Fairchance Rd  
Uniontown, PA 15401-  
ID:  
W: (724) 323-7105  
H:  
C:  
Email: neil.shultz@percheronllc.com

**Hough, Steven**

Loucks  
6784 Manchester Ave NE  
Otsego, MN 55330-  
ID: LS-28577  
W: (763) 496-6770  
H:  
C:  
Email: shough@loucksinc.com

**Orvik, Cody**

KLJ  
701 902 17th Ave SE  
Minot, ND 58701-  
ID:  
W:  
H:  
C:  
Email: cody.orvik@klgeng.com

**Alber, Jim**

Moore Engineering  
8321 White Oak Loop  
Bismarck, ND 58501-  
ID: LS-4730  
W: (701) 663-0718  
H:  
C:  
Email: jim.alber@mooreengineeringinc.com

## Membership Data

YEAR	LIFE	NSPS	PLS	LSI	NEW PLS	ASSOC	SUS	STUDENT	TOTAL
1979	0		78	0		?	?	?	133
1980	0		93	0		63	7	6	169
1981	0		107	0		73	9	2	191
1982	0		109	0		56	8	0	173
1983	0		104	0		61	8	1	174
1984	0		0	0		0	0	0	0
1985	0		107	0		38	6	0	151
1986	0		106	0		44	7	4	161
1987	0		101	0		46	6	4	157
1988	0		94	0		37	6	6	143
1989	0		88	0		44	7	0	139
1990	0		88	0		32	7	2	129
1991	0		76	0		28	5	2	111
1992	0		83	0		23	6	0	112
1993	0		68	9		21	5	0	103
1994	3		102	11		27	4	0	147
1995	3		108	11		25	7	2	156
1996	3		116	7		27	8	3	164
1997	1		114	8		21	8	1	153
1998	1		126	9		21	7	0	164
1999	1		112	8		26	8	1	156
2000	2		130	11		33	7	14	197
2001	6		126	11		28	4	8	183
2002	5		148	11		36	5	3	208
2003	6		132	10		36	6	1	191
2004	8		145	11	9	40	9	3	225
2005	10		133	17	7	45	9	2	223
2006	10		135	18	7	50	8	3	231
2007	11		133	23	3	47	7	1	225
2008	9		139	18	9	55	8	1	239
2009	12		136	17	30	59	8	4	266
2010	13		145	26	10	60	8	1	263
2011	15		153	27	14	64	8	1	282
2012	16		184	26	2	74	10	1	339
2013	16		195	26	2	61	8	1	309
2014	14	139	198	23	3	59	6	0	303
2015	12	170	212	20	1	77	5	1	328
2016	12	154	204	18	5	70	2	26	337
2017	14	132	191	18	1	61	5	2	292
2018	18	117	153	10	0	48	2	2	235
2019	22	138	142	9	1	50	2	1	227
2020	14		143	7		58			223
2021	21	133	134	7		60	2		224



