

2023 MEMBERSHIP DIRECTORY

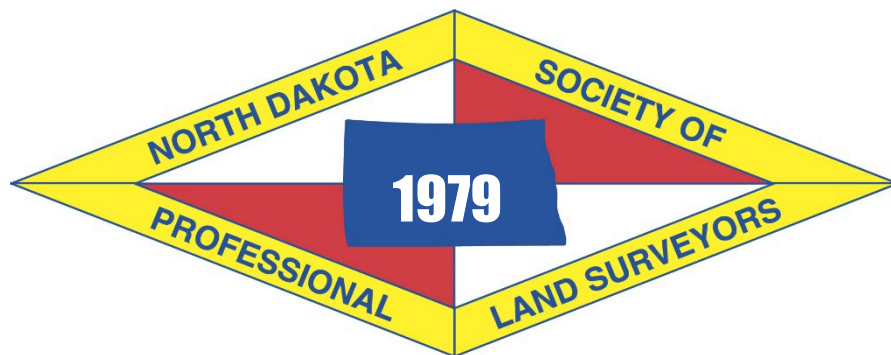

NORTH DAKOTA SOCIETY OF PROFESSIONAL LAND SURVEYORS

Affiliate of the National Society of Professional Surveyors

Table of Contents

Officers and Directors	2
Committees and Chairmen	2
Survey Excellence Awards.....	3
Past Presidents	3
Membership Listing.....	4
Membership Data	2

Membership Application
is now [online](#).

PO Box 7370
Bismarck, ND 58507
Phone: 701-222-3184
Email: admin@scgnd.com
Website: www.ndspls.org

2023 Officers & Directors

President
Carl Olson

President Elect
Robert Illg

Vice President
Jeff Jelinek

Secretary
Mark Isaacs

Treasurer
Tom Weigel

Past President
Tom Leshovsky

Flatlanders Chapter
Ryan Link

Badlands Chapter
Kirk Jorgenson

Great Plains Chapter
Dain Erickson

Missouri Breaks Chapter
Ed Rintamaki

Missouri River Chapter
Kris Johnson

Northern Lights
Tom Lambrecht

NSPS Director
Jason Ness

2023 Committees & Chairmen

Admin. Secretary Aaron Hummert
Awards..... Tom Leshovsky
Education Larry Smith
Education Assistance Program..... Brett Zeltinger
Ethics..... Jason Main
GIS..... Aaron Norby
Manual of Practice for Land Surveying in ND..... Robert Kohler
Historical..... LeRoy Kautz
Industry Committee Ed Rintamaki
Legislation & Bylaws..... Aaron Hummert
Membership Brett Zeltinger
Nominations Carl Olson
Policy & Procedures Manual Great Plains Chapter
Public Information Ken Link
Right of Entry Jason Ness
Tri-Star Jeff Jelinek
UAV Committee Seth Simonson
Web Site Dayne Solem & Brett Zeltinger
Young Surveyors Jordyn Hjeldness
New Datum Kris Johnson

NDSPLS Administrative Office

PO Box 7370

Bismarck, ND 58501

Staiger Consulting Group
Administrative Secretary

Phone: 701.223.3184

Email: info@ndspls.org

Website: www.ndspls.org

SURVEY EXCELLENCE AWARD

Russell E. Kastle	1987
Carl S. Vender	1988
Harold G. Lusk	1989
Alan W. Erickson	1990
Kenneth J. Link	1992
Doug Herzog	1996
Greg Johnson	1997
Steve Ackerman	1998
Ray LeClerc	1999
Mark Aughtman	2002
Rolly Ackerman	2003
Larry Smith	2004
Rick Leach	2005
Larry Smith	2006
Leland Krein	2008
LeRoy Kautz	2010
Brian Portwood	2013
Curt Glasoe	2014
Matt Weeks	2015
Bruce Zelmer	2016
LeRoy Kautz	2017
Aaron Hummert	2019
John Steve Perrish	2020

PAST PRESIDENTS

T. S. Madson	Feb 16, 1979
DeLane R. Meier	1979 1981
Carl S. Vender	1981 1983
Kenneth J. Link	1983 1984
Rodney A. Westrum	1984 1985
Rolly B. Ackerman	1985 1986
Douglas A. Herzog	1986 1987
Gregory L. Johnson	1987 1988
Michael P. Fandrich	1988 1989
Curtis W. Glasoe	1989 1990
Brian J. Rittenhouse	1990 1991
Donald F. Kaufman	1991 1992
Larry J. Smith	1992 1993
Rodney A. Westrum	1993 1994
Leo J. Horgan	1994 1995
Gary Bean	1995 1996
Steve Ackerman	1996 1997
Michael Zimny	1997 1998
Gary Ness	1998 1999
Robert D. Zahn	1999 2000
Roger Grimsley	2000 2001
Matt Weeks	2001 2002
Michael Sansom	2002 2003
Mark Aughtman	2003 2004
Rick Leach	2004 2005
Kent Orvik	2005 2006
Jim Alber	2006 2007
Steve Volesky	2007 2008
Dan Fischer	2008 2009
Robert Procive	2009 2010
Holly Beck	2010 2011
Kirk Jorgenson	2011 2012
Tim Langerud	2012 2013
Chris Jordheim	2013 2014
Steve Langlie	2014 2015
Gregg Orvik	2015 2016
Aaron Hummert	2016 2017
Charles Rebsch	2017 2018
Ed Rintamaki	2018 2019
Jason Main	2019 2020
Tom Leshovsky	2020 2021
Carl Olson	2021 2022

Ackerman, Rolly

Ackerman Surveying & Assoc.
1907 17th St SE
Minot, ND 58701-
ID: LS-2391
W: 701/838-0786
H: 701/838-3863
C:
Email: ackerman@minot.com

Ackerman, Steven

Ackerman Survey Ltd
8044 182 Ave SE
Wahpeton, ND 58075-
ID: LS-2958
W: (701) 899-4273
H:
C: 701/899-4273
Email: steve@ackermansurvey.com

Alber, James

Moore Engineering Inc.
8312 White Oak Loop
Bismarck, ND 58501-
ID: LS-4730
W: (701) 663-0718
H: 701/866-0286
C: (701) 866-0286
Email: jim.alber@mooreengineeringinc.com

Balluff, Thomas

Carlson McCain, Inc.
18612 Xenolith St NW
Anoka, MN 55303-
ID: LS-6064
W: (763) 489-7900
H:
C:
Email: tballuff@carlsonmccain.com

Baltzer, Terry

Swenson, Hagen & Co.
909 Basin Ave
Bismarck, ND 58504-
ID: LS-3595
W: 701/223-2600
H: 701/258-7053
C:
Email: tbaltzer@swensonhagen.com

Bartholomew, Branden

Self
1562 Kingsview Dr
Grand Forks, ND 58201-
ID: LS-3085
W: (218) 791-6964
H:
C: 218/791-6964
Email: b.bartholomew3085@gmail.com

Berg, Casey

Advanced Engineering
4050 Garden View Dr #200
Grand Forks, ND 58201-
ID: LS-7191
W: 701/746-8087
H: 701/739-4130
C: 701/740-5847
Email: casey.berg@ae2s.com

Bloomenrader, Scott

Retired
330 Rice Lane
Billings, MT 59105-
ID: LS-3290
W:
H: 406/252-2917
C:
Email: sbloomenrader@aol.com

Boers, Daniel

Boers Land Surveying and Mapping, Inc.
5277 W Cameron Bridge Rd
Manhattan, MT 59741-
ID: LS-5988
W:
H:
C:
Email: boerslandsurveying@outlook.com

Borgen, Jerome

Retired
10223 461 Ave
New Effington, SD 57255-6103
ID: LS-1406 - LIFE
W:
H: 605/637-5531
C:
Email: zborgens@tnics.com

Brecht, Mary

The Coteau Properties
204 County Road 15
Beulah, ND 58523-

ID: LS-3921
W: 701/873-7265
H:
C:

Email: mary.brecht@nacoal.com

Busta, Brian

Cass County Highway Department
120 Main Ave W
West Fargo, ND 58078-1301

ID: ASC
W: 701/298-2378
H:
C: 701/799-7714

Email: bustab@casscountynd.gov

Cichos, Nick

Interstate Engineering
P.O. Box 2035
Jamestown, ND 58401-

ID: ASC
W: 701/252-0234
H: 701/320-9045
C: 701/320-4293

Email: nick.cichos@interstateeng.com

Cooper, James

KLJ
405 6th Ave West
Dickinson, ND 58601-

ID: LS-5501
W: (701) 751-8378
H: 701/490-0921
C: (701) 456-3113

Email: james.cooper@kljeng.com

DANIELSON, BRADLEY

City of Grand Forks
1157 Lindsey Lane
Grand Forks, ND 58201-

ID: LS-3291
W: 701/280-8638
H: 701/866-4850
C:

Email: brddan@aol.com

Eckroth, Thomas

Retired
1621 Northview Lane
Bismarck, ND 58501-

ID: LS-3384
W: (701) 221-8415
H: 701/223-5681
C:

Email: teckroth@yahoo.com

Eldevik, Rodney

Eldevik Land Surveying, Inc.
1211 Maple Dr SE
Alexandria, MN 56308-

ID: LS-3409
W: 320/763-7566
H: 320/763-7566
C:

Email: eldevik@rea-alp.com

Erickson, Dain

Apex Engineering Group
3829 South Sedona Drive
West Fargo, ND 58078-

ID: LS-5582
W: (701) 373-7973
H:
C: 701/793-4382

Email: Dain.Erickson@ApexEngGroup.com

Fischer, Daniel

Fischer Land Surveying & Engineering
PO Box 66
Langdon, ND 58249-0066

ID: LS-3856
W: 701/256-5728
H:
C: 701/370-0690

Email: dfischer@utma.com

Frohlich, Jeff

RETIRED
622 N Mandan St
Bismarck, ND 58501-

ID: LS-3139
W: (701) 226-7954
H:
C: (701) 226-7954

Email: chefrolake@bis.midco.net

Frontier Precision,

Frontier Precision
2020 Frontier Drive
Bismarck, ND 58504-
ID: SUS
W: 701/222-2030
H:
C:
Email: nathank@frontierprecision.com

Glase, Curtis

Glase Surveying
1636 32nd ST E
Dickinson, ND 58601-
ID: LS-2439
W: (701) 260-9459
H: 701/225-5796
C: 701/260-9459
Email: curtglasoe@ndsupernet.com

Glasser, Jamie

Highlands Engineering & Surveying
319 24th Street E
Dickinson, ND 58601-
ID: LS-5771
W: 701/483-2444
H:
C:
Email: glasser@highlandseng.com

Greer, Gary

EnSite USA, Inc.
815 24th St
San Leon, TX 77539-
ID: LS-4129
W: (713) 456-7880
H:
C: (281) 787-1553
Email: garyg1954@yahoo.com

Herzog, Doug

3120 24th Ave S
Grand Forks, ND 58201-
ID: LS-2355 - Life
W:
H:
C: 701/739-0054
Email: daherzog@gra.midco.net

Hoffart, Brian

Minnkota Power
5301 32nd Ave S
Grand Forks, ND 58201-
ID: LS-5071
W: (701) 795-4000
H:
C: (701) 795-4000
Email: bhoffart@minnkota.com

Holm, Steven

Moore Engineering, Inc.
29926 70th Ave S
Hawley, MN 56549-
ID: LS-6571
W: (701) 282-4692
H:
C: (218) 850-0148
Email: steve.holm@mooreengineeringinc.com

Hornaday, Rick

Hornaday Land Surveying
2725 Heritage Drive
Minot, ND 58703-
ID: LS-3541
W: (701) 839-5502
H: 7018395502
C:
Email: soupbone17@gmail.com

Hurst, Lee

Erickson Contract Surveying, Inc.
615 5th St SE
Sidney, MT 59270-
ID: LS-9208
W: (406) 482-6606
H:
C: (406) 480-5263
Email: lee.hurst@ecs-gps.com

Indvik, Donald

Retired
606 W Pine Circle
Bottineau, ND 58318-
ID: LS-1263 - LIFE
W: (701) 201-0194
H: 701/228-2976
C: (701) 201-0194
Email: dindvik@utma.com

Irwin, Leland

Coteau Properties
PO Box 233
New Salem, ND 58563-
ID: LSIT-11872
W: (701) 873-2281
H: 701/843-8460
C:
Email: leland.irwin@nacoal.com

Jeffries, Jerry

Golden Field Services
419526 E 1070 Road
Checotah, OK 74426-
ID: LS-1247
W: (918) 610-0014
H:
C: 918/638-3317
Email: jljeffries@goldenfieldservices.com

Jelinek, Jeff

NDSCS
800 6th St N
Wahpeton, ND 58076-
ID: LS-5868
W: 701/671-2268
H:
C: (701) 671-2268
Email: jeff.jelinek@ndscs.edu

Jensen, Cleone

3837 N Valley Loop, Box 2
Bismarck, ND 58503-
ID: LS-1229 - LIFE
W:
H: 7017510618
C:
Email: jensenf@bis.midco.net

Jensen, Troy

Benchmark Land Surveying, Inc.
2036 Clover ct
Sidney, MT 59270-
ID: LS-4654
W: (406) 480-0906
H:
C: 406/480-0906
Email: tjensen@benchls.com

Johnson, Gregory

Gregory Johnson Surveying
6404 Deerewood Lane
Bismarck, ND 58503-
ID: LS-2356
W: (701) 220-2494
H:
C: (701) 220-2494
Email: duckschief@bis.midco.net

Johnson, Jared

Ward County Hwy Dept.
200 72nd ST SE
Ward County, ND 58701-
ID: ASC
W: 701/838-2810
H:
C:
Email: jaredjohnson@srt.com

Jorgenson, Kirk

KLJ
677 27th Ave East
Dickinson, ND 58601-
ID: LS-3592
W: 701/483-1284
H: 701/225-1644
C: 701/260-3638
Email: kirk.jorgenson@kljeng.com

Kautz, LeRoy

Interstate Engineering
248 19th Ave NE
Jamestown, ND 58401-
ID: LS-1177
W: 701/252-0234
H: 701/952-1177
C:
Email: ledodkautz@daktel.com

Kisch, Kurt

Ulteig
9867 Revere Lane
Maple Grove, MN 55369-
ID: LS-4597
W: (651) 415-6667
H: 763/425-2955
C: (612) 250-4533
Email: kkisch@comcast.net

Kohler, Robert

BEPC
1715 Valle Moor Dr
Bismarck, ND 58501-
ID: LS-6718
W: (701) 516-4434
H: 7015164434
C: (701) 516-4434
Email: rkohler@bepec.com

Krebs, Mathias

Retired
1123 9th St E
Dickinson, ND 58602-
ID: LS-3214 LIFE
W: (701) 300-2355
H:
C:
Email: matt.krebs97@gmail.com

Krug, Patrick

CPS, LTD
308 2nd Ave N
Grand Forks, ND 58201-
ID: LS-3289
W: (701) 746-7459
H:
C: (701) 330-1009
Email: pat.krug@cpsengineering.net

Langerud, Tim

Swenson, Hagen & Co.
909 Basin Ave
Bismarck, ND 58504-
ID: LS-5770
W: 701/223-2600
H:
C:
Email: tlangerud@swensonhagen.com

Leshovsky, Thomas

Wold Engineering, PC
110 8th Ave SW
Minot, ND 58701-
ID: LS-6134
W: 701/852-0338
H: 701/838-8305
C: 701/720-2416
Email: tomsky@woldengr.com

Liebold, Felix

KLJ
1010 4th Ave SW
Valley City, ND 58072-
ID: LS-8441
W: (701) 845-9426
H: 7017787342
C: 701/490-1340
Email: felix.liebold@kljeng.com

Link, Kenneth

Retired
613 4th Street NE
Hazen, ND 58545-
ID: LS-1242
W:
H: 701/748-2827
C:
Email: kenlink@westriv.com

Link, Ryan

CPS, LTD
308 2nd Ave N
Grand Forks, ND 58203-
ID: LS-7590
W: 701/746-7459
H:
C: (701) 740-2430
Email: ryan.link@cpsengineering.net

Loomer, Donald

4904 Prairie Lane
Williston, 58801-
ID: LS-2681
W:
H: 701/774-3674
C: (701) 770-2576
Email: dloomer@nemont.net

Madler, Charles

Retired
23 Tom Ral Drive
Spearfish, SD 57783-
ID: LS-2870
W: (406) 941-0886
H:
C: (406) 941-0886
Email: cmmadler@gmail.com

Manchester, Ronald

Toman Engineering Co
501 1st St NW
Mandan, ND 58554-
ID: LS-3252
W: (701) 663-6483
H:
C: (701) 400-9396
Email: ron@tomanengineering.com

Marquardt, Andra

Toman Engineering Co
402 7th St NW
Mandan, ND 58554-
ID: LS-4623
W: 701/663-6483
H: 701/667-2875
C:
Email: amarq013@yahoo.com

Marschall, Todd

Houston Engineering
88 McDougall Drive
Lincoln, ND 58504-
ID: LS-4431
W: (701) 323-0200
H:
C: (701) 527-2209
Email: tmarschall@houstoneng.com

McDonald, Dan

ND Department of Water Resources
1200 Memorial Highway
Bismarck, ND 58504-
ID: ASC
W: 701/328-3093
H:
C: (701) 202-6748
Email: dmcdonald@nd.gov

Mead, Todd

U.S. Fish and Wildlife Service
8295 28th St SE
Jamestown, ND 58401-
ID: LS-27123
W: (701) 355-8400
H:
C: (651) 491-9572
Email:
tmead@hotmail.com

Ness, Gary

Mead & Hunt
5516 15th St South
Fargo, ND 58102-
ID: LS-3461
W: (701) 566-6451
H:
C:
Email: gness1999@aol.com

Ness, Jason

Mead & Hunt, Inc.
1389 140th Ave NE
Hatton, ND 58240-
ID: LS-6884
W: (701) 566-6452
H:
C: (218) 779-8239
Email: jason.ness@meadhunt.com

Norby, Aaron

KLJ
4585 Coleman Street
Bismarck, ND 58503-
ID: LS-5589
W: (701) 355-8400
H: 7012232756
C:
Email: aaron.norby@kljeng.com

Norton, Todd

AE2S
4120 41st Ave
New Salem, ND 58563-
ID: LS-4624
W: 701/221-0530
H: 701/843-8719
C:
Email: Todd.Norton@ae2s.com

Obrigewitch, Greg

The Falkirk Mining Company
1513 Prairie Hawk Drive
Bismarck, ND 58503-
ID: LS-4114
W: 701/250-2412
H: 7018705469
C: 701/870-5469
Email: greg.obrigewitch@nacoal.com

Obrigewitsch, Quentin

KLJ
677 27th Ave East
Dickinson, ND 58601-
ID: LS-5999
W: 701/483-1284
H:
C: (701) 483-1284
Email: quentin.obrigewitsch@kljeng.com

Olson, Carl

KLJ Engineering LLC
1208 42nd Ave N
Fargo, ND 58102-
ID: LS-4687
W: 218/287-0300
H: 701/239-2518
C: 218/790-2931
Email: carl.olson@kljeng.com

Opsahl, Troy

City of West Fargo
800 4th Ave E
West Fargo, ND 58078-
ID: LSI-12008
W: 701/282-4692
H:
C: 701/793-0195
Email: troy.opsahl@westfargond.gov

Orvik, Gregg

Apex Engineering
4733 Amber Valley Pkwy S
Fargo, ND 58104-
ID: LS-3881
W: (701) 373-8033
H:
C:
Email: gregg.orvik@apexenggroup.com

Orvik, Kent

Retired
10129 Ewing Lane N
Brooklyn Park, MN 55443-
ID: LS-3463
W: (612) 404-4268
H:
C: (612) 404-4268
Email: kent.orvik@hotmail.com

Peterka, Daren

Interstate Engineering, Inc.
3210 6th Ave NW
Jamestown, ND 58401-
ID: LS-4358 - PE
W: 701/252-0234
H: 701/952-5238
C: 701/320-4292
Email: darenp@daktel.com;
daren.peterka@interstateeng.com

Powers, James

Red Plains Surveying Company
1917 S Harvard
Oklahoma City, OK 73128-
ID: LS-6050
W: (405) 603-7842
H: 4053543460
C: (405) 706-5626
Email: mick@rpsurveying.com

Pribula, Nicholas

Pribula Engineering, PLLC
3210 Belmont Rd
Grand Forks, ND 58201-
ID: LS-8587
W: (701) 772-7058
H:
C: (701) 388-8450
Email: npribula@gmail.com

Privratsky, James

1053 Dell Avenue
Dickinson, ND 58601-
ID: LS-3878 Life
W:
H: 701/225-1045
C: 701/260-2318
Email: ajjjsm@ndsupernet.com

Procive, Robert

Interstate Engineering, Inc
12760 35th St SW
Belfield, ND 58622-
ID: LS-2884
W: 701/575-2247
H: 701/575-4099
C: 701/290-5775
Email: rprocive@gmail.com

Richter, James

City of Grand Forks
255 N 4th St, PO Box 5200
Grand Forks, ND 58206-

ID: ASC

W:

H:

C:

Email: jrichter@grandforksgov.com

Rudolph, Kirby

Holly Beck Surveying & Engineering
3320 Hamilton St Unit 3
Bismarck, ND 58503-

ID: ASC

W: 701/223-3546

H: 7012264801

C:

Email: krudolph@hollybecksurveying.com

Sauber, John

Sauber Engineering
37 Captain Marsh Dr
Mandan, ND 58554-

ID: LS-8427

W: (701) 751-5993

H:

C:

Email: jsauber@sauberengineering.com

Schaar, Trevor

The Falkirk Mining Co.
5422 Dietrich Pl
Bismarck, ND 58503-

ID: PLS

W: (701) 250-2605

H: 7013917498

C:

Email: trevor.schaar@nacoal.com

Schlieman, Jim

Houston Engineering, Inc.
1401 21st Ave N
Fargo, ND 58102-

ID: LS-6086

W: 701/237-5065

H:

C:

Email: jschlieman@houstoneng.com

Seibel, Stanley

The Coteau Properties
204 County Road 15
Beulah, ND 58523-

ID: LS-3950

W: 701/873-7242

H: 701/748-6270

C:

Email: stan.seibel@nacoal.com

Skarphol, Curtis

Houston Engineering, Inc.
17135 54th Street SE
Horace, ND 58047-9600

ID: LS-4723

W: (701) 237-5065

H: 701/293-0827

C:

Email: cskarphol@houstonengineeringinc.com

Smith, Larry

SES Geomatics
2321 Harding Avenue
Bismarck, ND 58501-2233

ID: LS-2363

W: (701) 220-9843

H: 701/258-3827

C: (701) 220-9843

Email: ljs2363@midco.net

Solem, Dayne

Barlett & West
3456 E Century Ave
Bismarck, ND 58503-

ID: LS-8423

W: (701) 258-1110

H:

C: (701) 400-2785

Email: dayne.solem@bartwest.com

Stattelman, Nick

AE2S
4170 28th Avenue S
Fargo, ND 58104-

ID: LS-8218

W: (701) 364-9111

H: 218/230-4358

C: 218/230-4358

Email: Nick.Stattelman@ae2s.com

Swanson, Steven

AE2S
4050 Garden View Drive #200
Grand Forks, ND 58201-
ID: LS-4185
W: 701/746-8087
H:
C:
Email: Steve.Swanson@ae2s.com

Vender, Carl

Semi-Retired
6029 Linck Circle
Shepherd, MT 59079-4416
ID: LS-1222
W:
H: 4063730997
C:
Email: grandpavender@yahoo.com

Volesky, Steven

Retired
60 8th St W
Dickinson, ND 58601-
ID: LS-3367
W: 701/227-7855
H: 701/483-6992
C:
Email: svolesky@fs.fed.us

Walter, Alan

Ackerman-Estvold
805 Bavaria Drive
Minot, ND 58702-
ID: LS-1174
W: (701) 837-8737
H: 701/838-5258
C:
Email: alan.walter@ackerman-estvold.com

Weeks, Matthew

Interstate Engineering
PO Box 1132
Bismarck, ND 58502-
ID: LS-3626
W: (701) 471-8973
H: 701/255-2918
C: 701/471-8973
Email: matt.weeks@interstateeng.com

Westrum, Rodney

Retired
7010 3rd Ave E
Williston, ND 58801-
ID: LS-1195
W: (701) 774-8605
H: 7017740316
C: (701) 580-6327
Email: rwestrum@nemontel.net

Whetham, Allen

Retired
1007 23rd Ave S
Grand Forks, ND 58201-
ID: LS-2997
W:
H: 7013309403
C:
Email: azwhetham@yahoo.com

Wicklund, John

Oliver County
1119 University Dr #1016
Bismarck, ND 58504-
ID: LS-2491
W: 701/400-3797
H: 701/400-3797
C: 701/400-3797
Email: jjrw2492@aol.com

Wiens, Peter

Bartlett & West
3456 E Century Ave
Bismarck, ND 58503-
ID: ASC
W: 701/258-1110
H: 701/400-9377
C:
Email: pete.wiens@bartwest.com

Winkler, Scott

KLJ
1010 4TH Avenue SW
Valley City, ND 58072-
ID: ASC
W: 701/845-4980
H: 701/845-1151
C: 701/490-1614
Email: scott.winkler@kljeng.com

Zelmer, Bruce

Bartlett & West, INC
3456 E Century Ave
Bismarck, ND 58503-
ID: LS-5672
W: (701) 258-1110
H:
C: 701/226-2961
Email: bruce.zelmer@bartwest.com

Zimny, Michael

Meridian Land Surveys LLC
211 West Sweet Ave
Bismarck, ND 58504-5569
ID: LS-3132
W: (701) 258-2424
H:
C: (701) 258-2424
Email: dlandsurveys@aim.com

Wood, Jeremy

Northern Plains Engineering
441 23rd Street W
Dickinson, ND 58601-
ID: LS-5651
W: (701) 483-1858
H: 7014835080
C: (701) 690-8076
Email: jwood@nplainseng.com

Hummert, Aaron

Self-Employed
1901 31st St NW
Mandan, ND 58554-
ID: LS-7512
W:
H:
C: (701) 426-8624
Email: hummertsurveying@gmail.com

Carlson, Arlee

Sunde Land Surveying, LLC
9001 E Bloomington Frwy, #11B
Bloomington, MN 55420-
ID: LS-6373
W: (952) 881-2455
H: 7634278139
C: (612) 328-5312
Email: arlee@sunde.com

Johnson, Kris

NDDOT
2708 Mercury Lane
Bismarck, ND 58503-
ID: LS-10169
W: (701) 328-4330
H: 7019552387
C:
Email: kjjohnson@nd.gov

Coulombe, George

Coulombe Consulting
3701 Elliot Road NE
Bemidji, MN 56601-
ID: LS-6262
W: (218) 760-2508
H: 2184449791
C: (218) 760-2508
Email: cconsult@paulbunyan.net

Appleton, Robert

US Fish & Wildlife Service
10555 W Jewell Ave, Apt 10-303
Lakewood, CO 80232-
ID: LS-7176
W: (303) 829-8847
H:
C: (720) 413-4037
Email: appletonrj@q.com

Sagsveen, David

Bismarck State College
1530 Columbia Drive
Bismarck, ND 58504-
ID: ASC
W: (701) 224-5443
H:
C:
Email: david.sagsveen@bismarckstate.edu

KOLDEN, GREGORY

ND DOT
401 WEATHERBY WAY
Bismarck, ND 58503-
ID: LS-4722
W: (701) 328-3734
H: 7012500031
C:
Email: gregko1@bis.midco.net

Martin, Kevin

Bartlett & West
3456 E Century Ave
Bismarck, ND 58503-
ID: LS-7062
W: (701) 258-1110
H:
C: (701) 226-1261
Email: kevin.martin@bartwest.com

Hillius, Joe

Coteau Properties Company
204 County Road 15
Beulah, ND 58523-
ID: LSI
W:
H:
C: (701) 873-7234
Email: joe.hillius@nacoal.com

Forbes, Brian

D.R. Griffin & Associates, Inc.
1414 Elk Street #202
Rock Springs, WY 82901-
ID: LS-6611
W: (307) 362-5028
H: 3073829712
C:
Email: bforbes@drg-wy.com

Stroeing, Gregg

RETIRED
4298 Red River Trail SW
Pillager, MN 56473-
ID: LS-6703
W:
H:
C: (320) 333-5873
Email: greggstroeing@gmail.com

McCoy, Trace

Meyer-Rohlin Land Services
708 1st Ave NE #1
Buffalo, MN 55313-
ID: LS-6808
W: (763) 682-1781
H: 3205586091
C:
Email: trace@meyerrohlin.com

Jensen, Nicholas

Western Edge Surveying
1463 I-94 Business Loop East
Dickinson, ND 58601-
ID: PLS
W:
H:
C: (308) 430-3118
Email: jensen.nick89@gmail.com

Dolinar, William

William H Smith & Associates
1515 9th St Ste A
Rock Springs, WY 82901-
ID: LS-6550
W: (307) 875-3638
H: 3078751735
C:
Email: wdolinar@whsmithpc.com

Wisted, Bradley

Short Elliott Hendrickson, Inc
7712 White Overlook Drive
Breezy Point, MN 56472-
ID: LS-9841
W: (218) 290-2273
H: 2182902273
C:
Email: bwisted@sehinc.com

Stern, Matthew

Swenson, Hagen & Co.
909 Basin Ave
Bismarck, ND 58504-
ID: LS-8299
W: (701) 223-2600
H: 7019341969
C:
Email: mstern@swensonhagen.com

Strain, Miles

95West Aerial Mapping LLC
18391 Smith Ct
Elk River, MN 55330-
ID: PLS
W: (763) 420-9606
H:
C: (763) 442-3398
Email: Miles.Strain@95westaerial.com

Schirado, Dustin

Bartlett & West
3456 E. Century Ave
Bismarck, ND 58503-
ID: ASC
W: (701) 258-1110
H: 7015275988
C:
Email: dustin.schirado@bartwest.com

Wurgler, Jeremy

Houston Engineering, Inc.
4440 49th St S
Fargo, ND 58104-
ID: LS-6918
W: (701) 237-5065
H:
C: (701) 261-1392
Email: jwurgler@houstoneng.com

Erbele, Boyd

Apex Engineering Group
4733 Amber Valley Parkway S
Fargo, ND 58104-
ID: LS-7986
W: (701) 373-7978
H: 7017930086
C: (701) 793-0086
Email: Boyd.Erbele@ApexEngGroup.com

Rintamaki, Edward

49th Latitude Land Survey, LLC
13046 74th St NW
Alamo, ND 58830-
ID: LS-7664
W: (701) 580-2651
H:
C: (701) 580-2651
Email: erintamaki@49latitudelandsurvey.com

Small, Michael

MKEC Engineering
15931 E. Plymouth Road
Wichita, KS 67230-
ID: LS-8220
W: (316) 684-9600
H: 3167752781
C: (316) 259-9888
Email: msmall@mkec.com

Illg, Robert

SEH
4719 Shelburne Street #6
Bismarck, ND 58503-5677
ID: LS-8444
W: (701) 354-7121
H:
C: (218) 770-6647
Email: rillg@sehinc.com

Friedt, Jared

Houston Engineering, Inc.
5703 Copper Ridge Lane
Bismarck, ND 58504-
ID: PLS
W: (701) 323-0200
H: 7013230200
C:
Email: jfriedt@houstoneng.com

Jacobson, Matthew

IMEG
1817 South Avenue West, Suite A
Missoula, MT 59801-
ID: LS-7810
W: (406) 721-0142
H:
C: (701) 531-4959
Email: matthew.j.jacobson@imegcorp.com

Weigel, Tom

Holly Beck Surveying & Engineering
3320 Hamilton St., Unit 3
Bismarck, ND 58503-
ID: LS-10871
W: (701) 223-3546
H: 7014717430
C:
Email: tweigel@hollybecksurveying.com

Main, Jason

Ackerman Surveying & Assoc.
1824 11th St SW
Minot, ND 58701-
ID: LS-8134
W: (701) 838-0786
H:
C: (701) 509-3773
Email: jason.main@ackermansurveying.com

Jorgenson, Rob

Interstate Engineering
1260 W Villard St
Dickinson, ND 58601-
ID: ASC
W: (707) 575-2247
H:
C:
Email: rob.jorgenson@interstateeng.com

Buzzerd, Gregory

Wold Engineering
915 E 11th St, PO Box 237
Bottineau, ND 58318-
ID: LS-6985
W: (701) 228-2292
H: 9106197892
C:
Email: gbuzzerd@woldengr.com

Leas, Jarrett

KLJ
1024 Thiesse Dr
Brainerd, MN 56401-
ID: LS-8732
W: (218) 828-6330
H:
C: (218) 443-3830
Email: jarrett.leas@kljeng.com

Walsvik, Adam

Falkirk Mining Company
611 4th Ave
MANDAN, ND 58577-
ID: ASC
W: (701) 250-2614
H:
C: (701) 870-1246
Email: adam.walsvik@nacoal.com

Isaacs, Mark

Independent Land Surveying & Engineering, Inc.
4215 Old Red Trail NW
Mandan, ND 58554-
ID: LS-9628
W: (701) 595-2079
H:
C: (701) 595-2079
Email: mark@ilsurveynd.com

Ingersoll, Chris

KLJ
1601 4th Street S
Moorhead, MN 56560-
ID: LS-8887
W: (701) 232-5353
H:
C: (701) 367-1684
Email: chris.ingersoll@kljeng.com

Nelson, Joshua

RJN Survey
3518 21st St S
 Fargo, ND 58104-
ID: LS-27292
W: (701) 306-9685
H: 7013069685
C: (701) 306-9685
Email: josh@rjnsurvey.com

Brackey, Leon

Mountrail-Williams Electric Co-Op
1814 16th Ct W
Williston, ND 58801-
ID: 10135
W: (701) 577-3765
H: 7015720692
C: (701) 609-3115
Email: leonb@mwec.com

McKenzie, Malcolm

McKenzie Snyder, Inc.
996 18th Ave Cir N
Moorhead, MN 56560-
ID: ASC
W: (703) 298-5196
H:
C:
Email: mmckenzie@mckenziesnyder.com

Casavant, Kelcey

Swenson, Hagen & Co.
909 Basin Avenue
Bismarck, ND 58504-
ID: ASC
W: (701) 223-2600
H:
C:
Email: kcasavant@swensonhagen.com

Skipton, Bruce

Westwood Professional Services
2702 Serenity Drive
St. Cloud, MN 56301-
ID: LS-8251
W:
H:
C: (218) 760-1130
Email: bruceskipton@gmail.com

Cermak, Eric

Bartlett & West
3456 E Century Ave
Bismarck, ND 58503-
ID: ASC
W: (701) 258-1110
H:
C: (701) 425-7237
Email: eric.cermak@bartwest.com

Rosas, Antonio

Bartlett & West
3456 E Century Ave
Bismarck, ND 58503-
ID: ASC
W: (701) 258-1110
H:
C: (701) 527-4131
Email: antonio.rosas@bartwest.com

Zeltinger, Brett

Apex Engineering Group
600 S 2nd St
Bismarck, ND 58503-
ID: PLS-27331
W: (701) 818-7512
H:
C: (701) 721-6247
Email: brett.zeltinger@apexenggroup.com

Vosberg, Dusty

Interstate Engineering
204 2nd St
Wyndmere, ND 58051-
ID: PLS
W: (701) 642-5521
H:
C: (701) 640-9423
Email: dustyvosberg@gmail.com

Crow, Wayne

Williams County
5218 141st Ave NW
Williston, ND 58802-
ID: LS-8517
W: (701) 577-5118
H: 7016516021
C: (701) 570-4511
Email: waynec@co.williams.nd.us

Bullinger, Benjamin

Wold Engineering, PC
915 East 11th Street
Bottineau, ND 58318-
ID: LSI
W: (701) 871-7542
H:
C: (701) 201-0190
Email: ben_bullinger@woldengr.com

Kieso, Robert

Helms & Associates
416 N Production Street
Aberdeen, SD 57401-
ID: LS-7228
W: (605) 225-1212
H:
C: (605) 380-2711
Email: bobk@helmsengineering.com

Krumm, Hope

Houston Engineering
18 Custer Drive
Lincoln, ND 58504-
ID: ASC
W: (701) 323-0200
H:
C: (701) 851-0121
Email: hkrumm@houstoneng.com

Karel, Trent

Houston Engineering Inc.
1401 21st Ave N
Fargo, ND 58102-
ID: ASC
W:
H: 7015202197
C:
Email: tkarel@houstoneng.com

Letzring, Jim

SEH INC
4719 Shelburne St #16
Bismarck, ND 58501-
ID: ASC
W:
H: 7013610024
C: (307) 680-2589
Email: jim.letzring@woodgroup.com

Austin, Nathaniel

Wold Engineering, PC
110 8th Ave SW
Minot, ND 58701-
ID: LS-10415
W: (701) 852-0338
H:
C: (701) 822-4001
Email: naustin@srt.com

Huenefeld, Curtis

Swenson, Hagen, and CO
909 Basin Ave
Bismarck, ND 58504-
ID: PLS
W: (701) 223-2600
H:
C:
Email: chuenefeld@swensonhagen.com

Graham, Nicholas

Houston Engineering
111 Delaware St
Bismarck, ND 58504-
ID: ASC
W: (701) 323-0200
H: 7013403934
C:
Email: ngraham@houstoneng.com

Janes, Jason

Janes Surveying Inc.
PO Box 146
Palmyra, MO 63461-
ID:
W: (576) 769-7020
H:
C:
Email: jason@janessurveying.com

Taney, Maguire

Holly Beck Surveying
1056 Pleasant St
Bismarck, ND 58504-
ID: SUS
W: (701) 223-3546
H:
C: (575) 915-4218
Email: mtaney@hollybecksurveying.com

Thiel, Alex

Moore Engineering
925 10th Avenue E
West Fargo, ND 58078-
ID:
W: (701) 282-4692
H:
C:
Email: alex.thiel@mooreengineeringinc.com

Stephens, Brooke

USFW
3270 45th Avenue
New Salem, ND 58563-
ID: PLS
W:
H: 7012141829
C:
Email: brooke_stephens@fws.gov

Osse, Zane

Swenson, Hagen & Company
909 Basin Avenue
Bismarck, ND 58503-
ID: ASC
W: (701) 223-2600
H: 7018058944
C:
Email: zosse@swensonhagen.com

Wormley, Michael

L & D Surveying, LLC
2030 105th Ave SW
Manning, ND 58642-
ID: LS-28310
W:
H:
C: (701) 300-4702
Email: mwormley@ldsurveyingllc.com

Rintamaki, Ryan

49th Latitude Land Survey
522 9th Ave W
Williston, ND 58801-
ID: LSI
W: (701) 339-2006
H:
C:
Email:
rintamaki@49thlatitudelandsurvey.com

Bain, Robert

Northern Plains Energy
PO Box 1993
Dickinson, ND 58602-
ID: LS
W: (406) 359-7247
H:
C:
Email: rbain@nplainseng.com

Gilbertson, Jesse

AE2S
4050 Garden View Drive
Grand Forks, ND 58201-
ID: LSI
W:
H:
C: (701) 789-0816
Email:
jesse.gilbertson@ae2s.com

Hjeldness, Jordyn

Mead & Hunt
1060 2nd St E Apt 92
West Fargo, ND 58078-
ID: ASC
W:
H:
C:
Email: jordyn.hjeldness@meadhunt.com

Kauffman, Joseph

BIG SKY SURVEYING, PC
PO Box 170
Sidney, MT 59270-
ID: LS-9153
W: (406) 433-5617
H:
C: (406) 250-9452
Email: BIGSKYSurveying@Gmail.com

Osse, Orrin

Swenson, Hagen, and Co
4420 21st SE Apt 10
Mandan, ND 58554-
ID: ASC
W:
H:
C:
Email: oosse@swensonhagen.com

Fuller, Brent

AE2S
600 1st Ave N Apt 111
Grand Forks, ND 58203-
ID: LSI
W:
H:
C:
Email: brent.fuller@ae2s.com

Hinds, Matthew

Holly Beck Surveying and Engineering
1329 27th Ave SE
Minot, ND 58701-
ID: ASC
W:
H:
C:
Email: matthew.hinds@hollybecksurveying.com

Hartmann, Brian

SEH
1121 Gary Hunt Rd
Cocoa, FL 32926-
ID: ASC
W:
H:
C:
Email: bh.landsurveyor@yahoo.com

Isaacs, Marcus

ILSE, Inc.
4125 Old Red Trail NW
Mandan, ND 58554-
ID: ASC
W:
H:
C:
Email: marcus@ilsurveynd.com

Jensen, Brian

HDR In.c
101 South Phillips Ave, Suit 401
Sioux Falls, SD 57104-
ID: PLS
W:
H:
C:
Email: brian.jensen@hdrinc.com

Hastings, Reid

Interstate Engineering
805 1st Ave NW
Mandan, ND 58554-
ID: LSI
W:
H:
C:
Email: reid.hastings@interstateeng.com

Frey, Travis

Interstate Engineering
120 4th Ave SW
Beulah, ND 58523-
ID: LSI-29369
W:
H:
C:
Email: travis.frey@interstateeng.com

Hittle, Corey

Bartlett & West
3456 E Century Ave
Bismarck, ND 58503-
ID:
W:
H:
C:
Email: corey.hittle@bartwest.com

Edmunds, Isaiah

Mead & Hunt
2505 N University Drive Apt 100
Fargo, ND 58102-
ID:
W:
H:
C:
Email: isaiah.edmunds@meadhunt.com

Beard, Matthew

TD&H Engineering
204 6th Street NE
Watford City, ND 58854-
ID: LS-29538
W:
H:
C:
Email: matt.beard@hotmail.com

Schoot, Eric

1400 Rivew View Ave Apt E3
Sevens Point, WI 54481-
ID:
W:
H:
C:
Email: scer1528@gmail.com

ID:
W:
H:
C:
Email:

Membership Data

YEAR	LIFE	NSPS	PLS	LSI	NEW PLS	ASSOC	SUS	STUDENT	TOTAL
1979	0		78	0		?	?	?	133
1980	0		93	0		63	7	6	169
1981	0		107	0		73	9	2	191
1982	0		109	0		56	8	0	173
1983	0		104	0		61	8	1	174
1984	0		0	0		0	0	0	0
1985	0		107	0		38	6	0	151
1986	0		106	0		44	7	4	161
1987	0		101	0		46	6	4	157
1988	0		94	0		37	6	6	143
1989	0		88	0		44	7	0	139
1990	0		88	0		32	7	2	129
1991	0		76	0		28	5	2	111
1992	0		83	0		23	6	0	112
1993	0		68	9		21	5	0	103
1994	3		102	11		27	4	0	147
1995	3		108	11		25	7	2	156
1996	3		116	7		27	8	3	164
1997	1		114	8		21	8	1	153
1998	1		126	9		21	7	0	164
1999	1		112	8		26	8	1	156
2000	2		130	11		33	7	14	197
2001	6		126	11		28	4	8	183
2002	5		148	11		36	5	3	208
2003	6		132	10		36	6	1	191
2004	8		145	11	9	40	9	3	225
2005	10		133	17	7	45	9	2	223
2006	10		135	18	7	50	8	3	231
2007	11		133	23	3	47	7	1	225
2008	9		139	18	9	55	8	1	239
2009	12		136	17	30	59	8	4	266
2010	13		145	26	10	60	8	1	263
2011	15		153	27	14	64	8	1	282
2012	16		184	26	2	74	10	1	339
2013	16		195	26	2	61	8	1	309
2014	14	139	198	23	3	59	6	0	303
2015	12	170	212	20	1	77	5	1	328
2016	12	154	204	18	5	70	2	26	337
2017	14	132	191	18	1	61	5	2	292
2018	18	117	153	10	0	48	2	2	235
2019	22	138	142	9	1	50	2	1	227
2020	14		143	7		58			223
2021	21	134	135	7	3	31	3		198
2022	11	119	121	5	2	29	1	1	169

